

Water fittings

Water

Bench mounted

Bench mounted right hand fitting with fixed swanneck and fixed nozzle.

Weight: Approx. 1.3 kg

| | |
|-----------------------|---|
| XL 34 013 82 XX - 14E | 60 mm, 1/2" ISO 7/1-R - UniFlex™ Hose: 0,7m with 1/2" union nut * |
| XL 34 013 82 XX - 14H | 60 mm, 1/2" ISO 7/1-R - UniFlex™ Hose: 0,7m with OD15mm brass tail * |

Available for various media. Please replace XX with the relevant media:

-  01 - Water potable, cold (WPC)
-  02 - Water potable, hot (WPH)
-  07 - Water non-potable, cold (WNC)
-  08 - Water non-potable, hot (WNH)

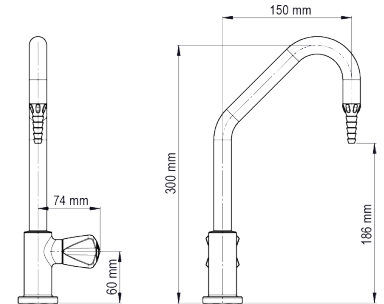

Water

Bench mounted

Bench mounted left hand fitting with fixed swanneck and fixed nozzle.

Weight: Approx. 1.3 kg

| | |
|-----------------------|---|
| XL 34 011 82 XX - 14E | 60 mm, 1/2" ISO 7/1-R - UniFlex™ Hose: 0,7m with 1/2" union nut * |
| XL 34 011 82 XX - 14H | 60 mm, 1/2" ISO 7/1-R - UniFlex™ Hose: 0,7m with OD15mm brass tail * |

Available for various media. Please replace XX with the relevant media:

-  01 - Water potable, cold (WPC)
-  02 - Water potable, hot (WPH)
-  07 - Water non-potable, cold (WNC)
-  08 - Water non-potable, hot (WNH)

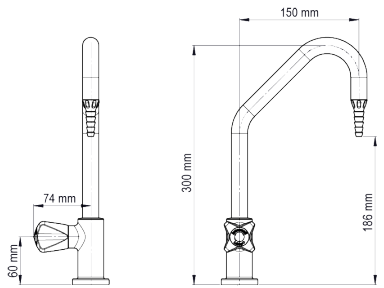
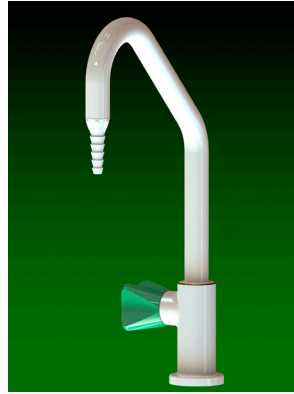

Water

Bench mounted

Bench mounted fitting with swivel swanneck and fixed nozzle.

Weight: Approx. 1.3 kg

| | |
|-----------------------|---|
| XL 34 008 82 XX - 14E | 60 mm, 1/2" ISO 7/1-R - UniFlex™ Hose: 0,7m with 1/2" union nut * |
| XL 34 008 82 XX - 14H | 60 mm, 1/2" ISO 7/1-R - UniFlex™ Hose: 0,7m with OD15mm brass tail * |

Available for various media. Please replace XX with the relevant media:

-  01 - Water potable, cold (WPC)
-  02 - Water potable, hot (WPH)
-  07 - Water non-potable, cold (WNC)
-  08 - Water non-potable, hot (WNH)

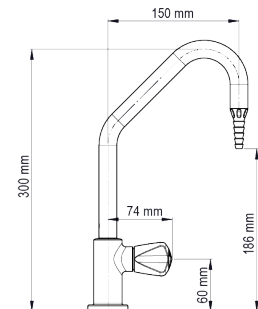
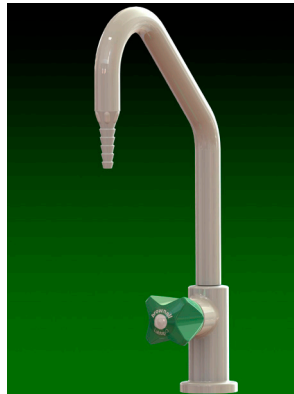

* See page 25 for information on Inlet design, drilling template and information about tread.

Water fittings

Water

Bench mounted

Bench mounted pillar angle fitting with fixed nozzle.

Weight: Approx. 1.5 kg

| | |
|-----------------------|---|
| XL 33 085 82 XX - 14E | 60 mm, 1/2" ISO 7/1-R - UniFlex™ Hose: 0,7m with 1/2" union nut * |
| XL 33 085 82 XX - 14H | 60 mm, 1/2" ISO 7/1-R - UniFlex™ Hose: 0,7m with OD15mm brass tail * |

Available for various media. Please replace XX with the relevant media:

-  01 - Water potable, cold (WPC)
-  02 - Water potable, hot (WPH)
-  07 - Water non-potable, cold (WNC)
-  08 - Water non-potable, hot (WNH)

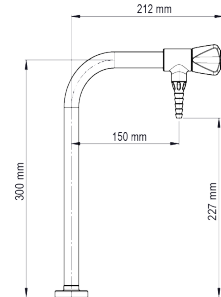

Water

Bench mounted

Bench mounted two-way U-shape fitting with fixed nozzle.

Weight: Approx. 2.5 kg

| | |
|-----------------------|---|
| XL 33 086 82 XX - 14E | 60 mm, 1/2" ISO 7/1-R - UniFlex™ Hose: 0,7m with 1/2" union nut * |
| XL 33 086 82 XX - 14H | 60 mm, 1/2" ISO 7/1-R - UniFlex™ Hose: 0,7m with OD15mm brass tail * |

Available for various media. Please replace XX with the relevant media:

-  01 - Water potable, cold (WPC)
-  02 - Water potable, hot (WPH)
-  07 - Water non-potable, cold (WNC)
-  08 - Water non-potable, hot (WNH)

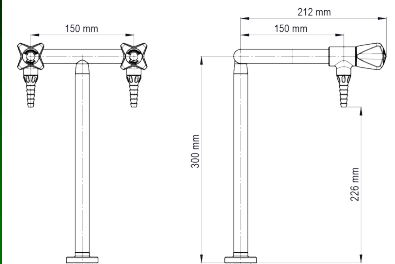

Water

Bench mounted

Bench mounted two-way T-shape fitting with fixed nozzle.

Weight: Approx. 2.5 kg

| | |
|-----------------------|---|
| XL 33 087 82 XX - 14E | 60 mm, 1/2" ISO 7/1-R - UniFlex™ Hose: 0,7m with 1/2" union nut * |
| XL 33 087 82 XX - 14H | 60 mm, 1/2" ISO 7/1-R - UniFlex™ Hose: 0,7m with OD15mm brass tail * |

Available for various media. Please replace XX with the relevant media:

-  01 - Water potable, cold (WPC)
-  02 - Water potable, hot (WPH)
-  07 - Water non-potable, cold (WNC)
-  08 - Water non-potable, hot (WNH)

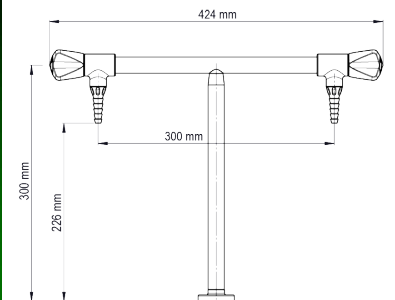

Water

Bench mounted

Bench mounted two side arms, swivel swanneck and fixed nozzle.

Weight: Approx. 3.5 kg

| | |
|-----------------------|---|
| XL 33 094 82 XX - 14E | 60 mm, 1/2" ISO 7/1-R - UniFlex™ Hose: 0,7m with 1/2" union nut * |
| XL 33 094 82 XX - 14H | 60 mm, 1/2" ISO 7/1-R - UniFlex™ Hose: 0,7m with OD15mm brass tail * |

Available for various media. Please replace XX with the relevant media:

-  01 - Water potable, cold (WPC)
-  02 - Water potable, hot (WPH)
-  07 - Water non-potable, cold (WNC)
-  08 - Water non-potable, hot (WNH)

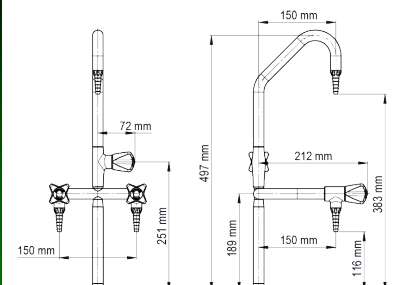

* See page 25 for information on Inlet design, drilling template and information about tread.

Water fittings

Water

Bench mounted

Bench mounted right hand fitting with fixed swanneck and pipe interruptor

Weight: Approx. 1.4 kg

| | |
|-----------------------|---|
| XL 34 072 82 XX - 14E | 60 mm, 1/2" ISO 7/1-R - UniFlex™ Hose: 0,7m with 1/2" union nut * |
| XL 34 072 82 XX - 14H | 60 mm, 1/2" ISO 7/1-R - UniFlex™ Hose: 0,7m with OD15mm brass tail * |

Available for various media. Please replace XX with the relevant media:

-  01 - Water potable, cold (WPC)
-  02 - Water potable, hot (WPH)
-  07 - Water non-potable, cold (WNC)
-  08 - Water non-potable, hot (WNH)

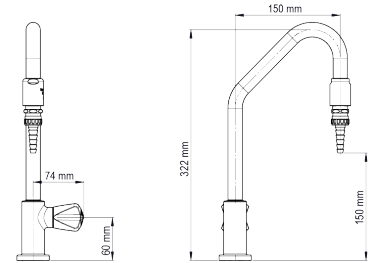

Water

Bench mounted

Bench mounted left hand fitting with fixed swanneck and pipe interruptor

Weight: Approx. 1.4 kg

| | |
|-----------------------|---|
| XL 34 073 82 XX - 14E | 60 mm, 1/2" ISO 7/1-R - UniFlex™ Hose: 0,7m with 1/2" union nut * |
| XL 34 073 82 XX - 14H | 60 mm, 1/2" ISO 7/1-R - UniFlex™ Hose: 0,7m with OD15mm brass tail * |

Available for various media. Please replace XX with the relevant media:

-  01 - Water potable, cold (WPC)
-  02 - Water potable, hot (WPH)
-  07 - Water non-potable, cold (WNC)
-  08 - Water non-potable, hot (WNH)

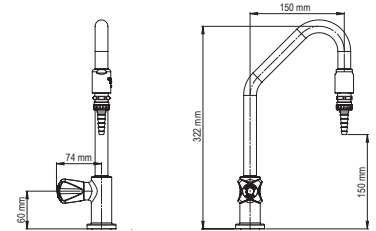

Water

Bench mounted

Bench mounted fitting with swivel swanneck and pipe interruptor

Weight: Approx. 1.4 kg

| | |
|-----------------------|---|
| XL 34 071 82 XX - 14E | 60 mm, 1/2" ISO 7/1-R - UniFlex™ Hose: 0,7m with 1/2" union nut * |
| XL 34 071 82 XX - 14H | 60 mm, 1/2" ISO 7/1-R - UniFlex™ Hose: 0,7m with OD15mm brass tail * |

Available for various media. Please replace XX with the relevant media:

-  01 - Water potable, cold (WPC)
-  02 - Water potable, hot (WPH)
-  07 - Water non-potable, cold (WNC)
-  08 - Water non-potable, hot (WNH)

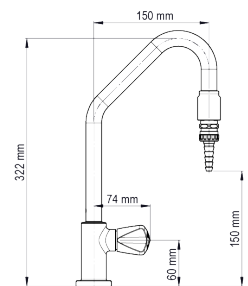

Water

Bench mounted

Bench mounted pillar angle fitting with pipe interruptor

Weight: Approx. 1.4 kg

| | |
|-----------------------|---|
| XL 33 222 82 XX - 14E | 60 mm, 1/2" ISO 7/1-R - UniFlex™ Hose: 0,7m with 1/2" union nut * |
| XL 33 222 82 XX - 14H | 60 mm, 1/2" ISO 7/1-R - UniFlex™ Hose: 0,7m with OD15mm brass tail * |

Available for various media. Please replace XX with the relevant media:

-  01 - Water potable, cold (WPC)
-  02 - Water potable, hot (WPH)
-  07 - Water non-potable, cold (WNC)
-  08 - Water non-potable, hot (WNH)

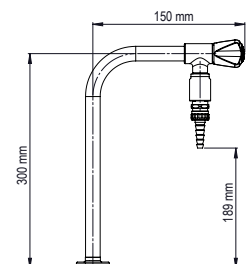

* See page 25 for information on Inlet design, drilling template and information about tread.

Water mixers

Water

Bench mounted

Bench mounted mixer fitting with areator

Weight: Approx. 2.2 kg

| | |
|-----------------------|---|
| XL 36 152 82 XX - 14E | 60 mm, 1/2" ISO 7/1-R - UniFlex™ Hose: 0,7m with 1/2" union nut * |
| XL 36 152 82 XX - 14H | 60 mm, 1/2" ISO 7/1-R - UniFlex™ Hose: 0,7m with OD15mm brass tail * |

Available for various media. Please replace XX with the relevant media:

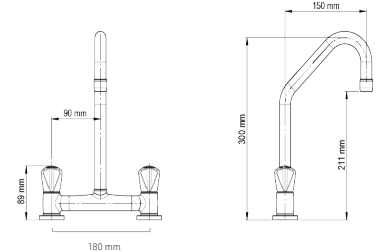
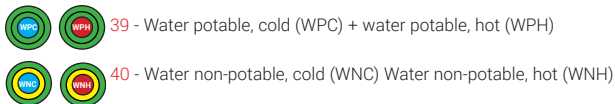

Water

Bench mounted

Bench mounted mixer fitting with areator and wrist action levers

Weight: Approx. 2.5 kg

| | |
|-----------------------|---|
| XL 36 171 82 XX - 14E | 60 mm, 1/2" ISO 7/1-R - UniFlex™ Hose: 0,7m with 1/2" union nut * |
| XL 36 171 82 XX - 14H | 60 mm, 1/2" ISO 7/1-R - UniFlex™ Hose: 0,7m with OD15mm brass tail * |

Available for various media. Please replace XX with the relevant media:

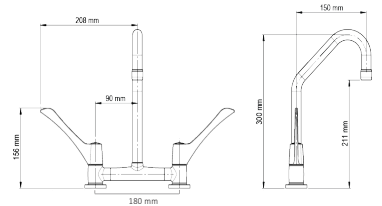
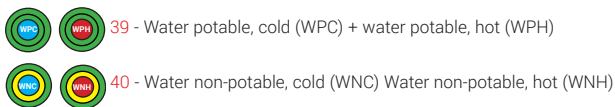

Water / Divided flow

Bench mounted

Bench mounted divided flow mixer with areator

Weight: Approx. 2.2 kg

| | |
|-----------------------|---|
| XL 36 155 82 XX - 14E | 60 mm, 1/2" ISO 7/1-R - UniFlex™ Hose: 0,7m with 1/2" union nut * |
| XL 36 155 82 XX - 14H | 60 mm, 1/2" ISO 7/1-R - UniFlex™ Hose: 0,7m with OD15mm brass tail * |

Available for various media. Please replace XX with the relevant media:

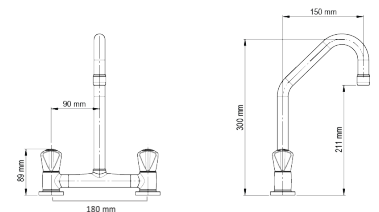
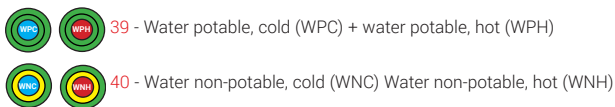

Water / Divided flow

Bench mounted

Bench mounted divided flow mixer with areator and wrist action levers.

Weight: Approx. 2.5 kg

| | |
|-----------------------|---|
| XL 36 154 82 XX - 14E | 60 mm, 1/2" ISO 7/1-R - UniFlex™ Hose: 0,7m with 1/2" union nut * |
| XL 36 154 82 XX - 14H | 60 mm, 1/2" ISO 7/1-R - UniFlex™ Hose: 0,7m with OD15mm brass tail * |

Available for various media. Please replace XX with the relevant media:

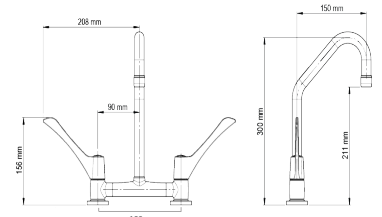
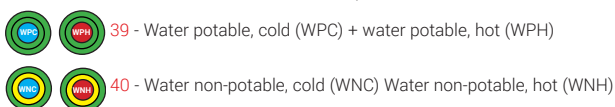

* See page 25 for information on Inlet design, drilling template and information about tread.

brownall Labtap®

Water mixers

Water



Bench mounted

Bench mounted single hole mixer with swivel swanneck and fixed nozzle.

Weight: Approx. 2.2 kg

| | |
|-----------------------|--|
| XL 36 039 82 XX - 52E | 60 mm, m30x1.5, Pipe: 0,7m pipe with 1/2" union nut * |
| XL 36 039 82 XX - 52H | 60 mm, m30x1.5, Hose: 0,7m with OD15mm brass tail * |

Available for various media. Please replace XX with the relevant media:

-  39 - Water potable, cold (WPC) + water potable, hot (WPH)
-  40 - Water non-potable, cold (WNC) Water non-potable, hot (WNH)

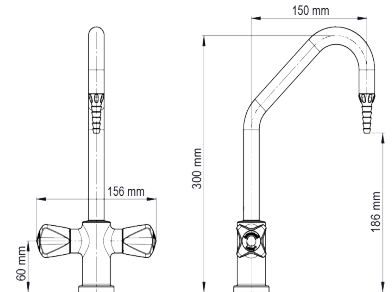

Water



Bench mounted

Bench mounted single hole mixer with swivel swanneck and fixed nozzle and wrist action levers.

Weight: Approx. 2.5 kg

| | |
|-----------------------|--|
| XL 36 041 82 XX - 52E | 60 mm, m30x1.5, Pipe: 0,7m pipe with 1/2" union nut * |
| XL 36 041 82 XX - 52H | 60 mm, m30x1.5, Hose: 0,7m with OD15mm brass tail * |

Available for various media. Please replace XX with the relevant media:

-  39 - Water potable, cold (WPC) + water potable, hot (WPH)
-  40 - Water non-potable, cold (WNC) Water non-potable, hot (WNH)

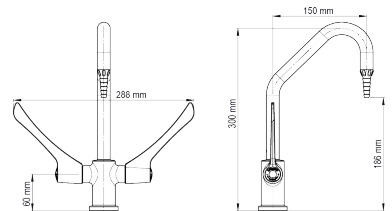

* See page 25 for information on Inlet design, drilling template and information about tread.