

# **brownall** Labtap®

Laboratory fittings for educational use

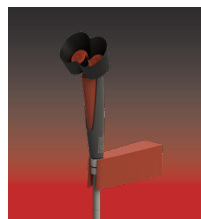

## Contents

Benefits of Brownall Labtap .....	2
Handle colour coding .....	3
General informations .....	3
Water taps .....	4
Water mixers .....	7
Lift/turn taps .....	9
Emergency shower systems .....	12
Chemical and waste .....	15
Sinks and waste .....	17
Accessories .....	18
Technical information .....	21
Headworks .....	23
Inlet and connection overview .....	24
Product number configurator .....	25

## Benefits of brownall Labtap®

### Vandal resistant fittings standard



*Suitable for both educational & scientific markets.*

### Polyester powder coating



*Better chemical/UV light and heat resistance than chrome.*

### Quality controlled



*Every valve is tested at the factory.*

### Colour coded handles



*Chemical symbols according to BS EN 13792:2002 norm for convenient indication of media.*

### Aerator or serrated nozzle available on all water fittings



*Flexible product line.*

### Replaceable headworks



*Easy maintenance.*

### Specialized headworks



*For different media secures precise flow and regulation.*

### Exchangeable nozzles



*Flexible choice of outlet connections.*

Handle colour coding

Water fittings



Water potable, cold (WPC)



Water potable, hot (WPH)



Water non-potable, cold (WNC)



Water non-potable, hot (WNH)

Lift/turn fittings



Natural gas (G)



Liquified petrol gas (LPG)

General informations

Materials

Laboratory fittings from **brownall Labtap®** are manufactured of the highest quality materials, primarily brass. Stainless steel is also used where required. The surfaces of all fittings are finished in chemically resistant polyester-powder coat.

Installation and technical tables

Special requirements of your local Water and Gas board should be checked before commencing installation. All pipe work should be purged to ensure cleanliness before fitting. Filters should be fitted if medium used is impure. Technical information is located in the following pages, including working pressures and description of materials used.

Special advantages

The laboratory fittings from **brownall Labtap®** are designed and manufactured with the requirements of a modern laboratory in mind. The hallmarks of these fittings are good performance, durability, easy operation, flexibility and streamlined design, along with an easy-to-clean and attractive appearance. Fittings from **brownall Labtap®** are ideal for all types of laboratories, and are delivered with easy-to-mount fixing items/mounting kit, that will keep the fitting fully locked in its position when installed. Consequently, the fitting will not turn unintentionally, which would result in leaks.

Pressure conversion			
	bar	Pa	psi
1 bar =	1	1x10 <sup>5</sup>	14.5
1 Pa =	1x10 <sup>-5</sup>	1	1.45x10 <sup>-4</sup>
1 psi =	6.9x10 <sup>-2</sup>	6.9x10 <sup>3</sup>	1

Example: 67 psi = 67x(6.9x10<sup>-2</sup>) = 4.6 bar

## Water taps

### Water

### Bench mounted

Bench mounted right hand fitting with fixed swanneck and fixed nozzle.

Weight: Approx. 1.3 kg

XL 34 013 82 XX - 14	60 mm, 1/2" ISO 7/1-R - UniFlex™ *
XL 34 013 82 XX - 14H	60 mm, 1/2" ISO 7/1-R - UniFlex™ Hose: 0,7m with OD15mm brass tail *

Available for various media. Please replace XX with the relevant media:



01 - Water potable, cold (WPC)



02 - Water potable, hot (WPH)



07 - Water non-potable, cold (WNC)



08 - Water non-potable, hot (WNH)

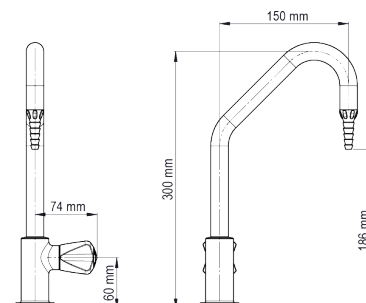

### Water

### Bench mounted

Bench mounted left hand fitting with fixed swanneck and fixed nozzle.

Weight: Approx. 1.3 kg

XL 34 011 82 XX - 14	60 mm, 1/2" ISO 7/1-R - UniFlex™ *
XL 34 011 82 XX - 14H	60 mm, 1/2" ISO 7/1-R - UniFlex™ Hose: 0,7m with OD15mm brass tail *

Available for various media. Please replace XX with the relevant media:



01 - Water potable, cold (WPC)



02 - Water potable, hot (WPH)



07 - Water non-potable, cold (WNC)



08 - Water non-potable, hot (WNH)

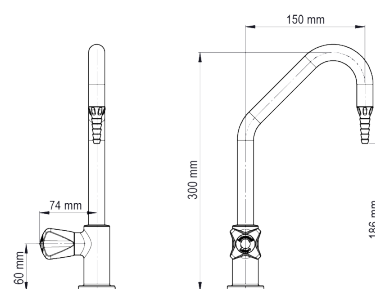

### Water

### Bench mounted

Bench mounted fitting with swivel swanneck and fixed nozzle.

Weight: Approx. 1.3 kg

XL 34 008 82 XX - 14	60 mm, 1/2" ISO 7/1-R - UniFlex™ *
XL 34 008 82 XX - 14H	60 mm, 1/2" ISO 7/1-R - UniFlex™ Hose: 0,7m with OD15mm brass tail *

Available for various media. Please replace XX with the relevant media:



01 - Water potable, cold (WPC)



02 - Water potable, hot (WPH)



07 - Water non-potable, cold (WNC)



08 - Water non-potable, hot (WNH)

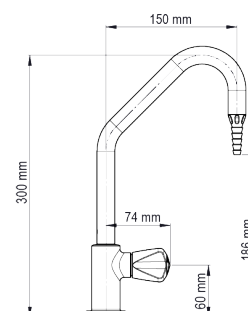

## Water taps

### Water

### Bench mounted

Bench mounted pillar angle fitting with fixed nozzle.

Weight: Approx. 1.5 kg

XL 33 085 82 XX - 14	60 mm, 1/2" ISO 7/1-R - UniFlex™ *
XL 33 085 82 XX - 14H	60 mm, 1/2" ISO 7/1-R - UniFlex™ Hose: 0,7m with OD15mm brass tail *

Available for various media. Please replace XX with the relevant media:

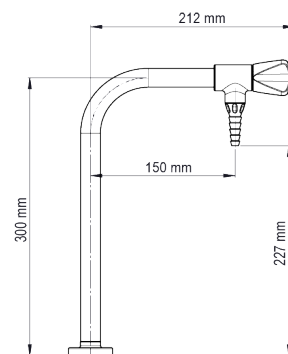

### Water

### Bench mounted

Bench mounted two-way U-shape fitting with fixed nozzle.

Weight: Approx. 2.5 kg

XL 33 086 82 XX - 14	60 mm, 1/2" ISO 7/1-R - UniFlex™ *
XL 33 086 82 XX - 14H	60 mm, 1/2" ISO 7/1-R - UniFlex™ Hose: 0,7m with OD15mm brass tail *

Available for various media. Please replace XX with the relevant media:

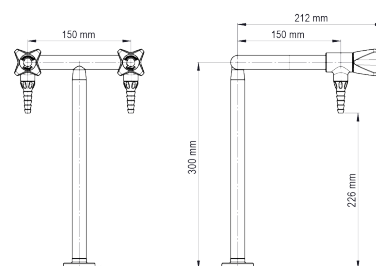
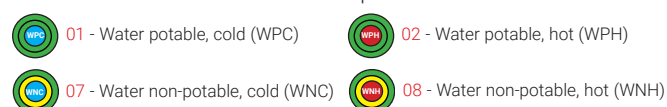

### Water

### Bench mounted

Bench mounted two-way T-shape fitting with fixed nozzle.

Weight: Approx. 2.5 kg

XL 33 087 82 XX - 14	60 mm, 1/2" ISO 7/1-R - UniFlex™ *
XL 33 087 82 XX - 14H	60 mm, 1/2" ISO 7/1-R - UniFlex™ Hose: 0,7m with OD15mm brass tail *

Available for various media. Please replace XX with the relevant media:

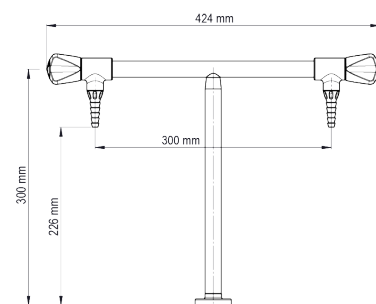

### Water

### Bench mounted

Bench mounted two side arms, swivel swanneck and fixed nozzle.

Weight: Approx. 3.5 kg

XL 33 094 82 XX - 14	60 mm, 1/2" ISO 7/1-R - UniFlex™ *
XL 33 094 82 XX - 14H	60 mm, 1/2" ISO 7/1-R - UniFlex™ Hose: 0,7m with OD15mm brass tail *

Available for various media. Please replace XX with the relevant media:

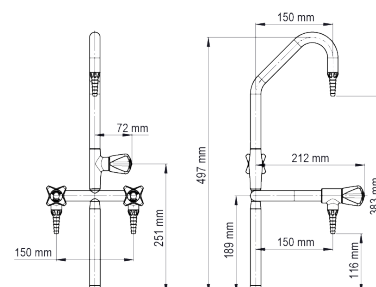

\* See page 25 for information on Inlet design, drilling template and information about thread.

## Water taps

### Water

### Bench mounted

Bench mounted right hand fitting with fixed swanneck and pipe interruptor

Weight: Approx. 1.4 kg

XL 34 072 82 XX - 14	60 mm, 1/2" ISO 7/1-R - UniFlex™ Hose: 0,7m with 1/2" union nut *
XL 34 072 82 XX - 14H	60 mm, 1/2" ISO 7/1-R - UniFlex™ Hose: 0,7m with OD15mm brass tail *

Available for various media. Please replace XX with the relevant media:



01 - Water potable, cold (WPC)



02 - Water potable, hot (WPH)



07 - Water non-potable, cold (WNC)



08 - Water non-potable, hot (WNH)

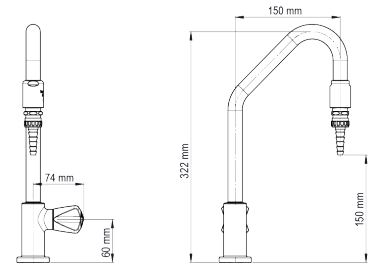

### Water

### Bench mounted

Bench mounted left hand fitting with fixed swanneck and pipe interruptor

Weight: Approx. 1.4 kg

XL 34 073 82 XX - 14	60 mm, 1/2" ISO 7/1-R - UniFlex™ *
XL 34 073 82 XX - 14H	60 mm, 1/2" ISO 7/1-R - UniFlex™ Hose: 0,7m with OD15mm brass tail *

Available for various media. Please replace XX with the relevant media:



01 - Water potable, cold (WPC)



02 - Water potable, hot (WPH)



07 - Water non-potable, cold (WNC)



08 - Water non-potable, hot (WNH)

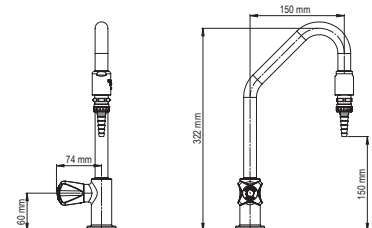

### Water

### Bench mounted

Bench mounted fitting with swivel swanneck and pipe interruptor

Weight: Approx. 1.4 kg

XL 34 071 82 XX - 14	60 mm, 1/2" ISO 7/1-R - UniFlex™ *
XL 34 071 82 XX - 14H	60 mm, 1/2" ISO 7/1-R - UniFlex™ Hose: 0,7m with OD15mm brass tail *

Available for various media. Please replace XX with the relevant media:



01 - Water potable, cold (WPC)



02 - Water potable, hot (WPH)



07 - Water non-potable, cold (WNC)



08 - Water non-potable, hot (WNH)

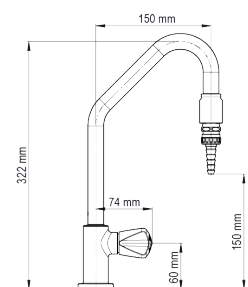

### Water

### Bench mounted

Bench mounted pillar angle fitting with pipe interruptor

Weight: Approx. 1.4 kg

XL 33 222 82 XX - 14	60 mm, 1/2" ISO 7/1-R - UniFlex™ *
XL 33 222 82 XX - 14H	60 mm, 1/2" ISO 7/1-R - UniFlex™ Hose: 0,7m with OD15mm brass tail *

Available for various media. Please replace XX with the relevant media:



01 - Water potable, cold (WPC)



02 - Water potable, hot (WPH)



07 - Water non-potable, cold (WNC)



08 - Water non-potable, hot (WNH)

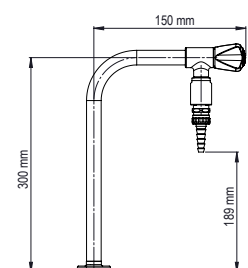

\* See page 25 for information on Inlet design, drilling template and information about thread.



## Water mixers

### Water

### Bench mounted

Bench mounted mixer fitting with areator

Weight: Approx. 2.2 kg

XL 36 152 82 XX - 14	60 mm, 1/2" ISO 7/1-R - UniFlex™ *
XL 36 152 82 XX - 14H	60 mm, 1/2" ISO 7/1-R - UniFlex™ Hose: 0,7m with OD15mm brass tail *

Available for various media. Please replace XX with the relevant media:

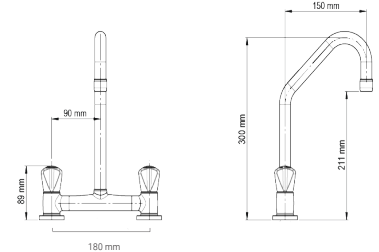
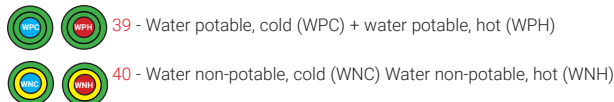

### Water

### Bench mounted

Bench mounted mixer fitting with areator and wrist action levers

Weight: Approx. 2.5 kg

XL 36 171 82 XX - 14	60 mm, 1/2" ISO 7/1-R - UniFlex™ *
XL 36 171 82 XX - 14H	60 mm, 1/2" ISO 7/1-R - UniFlex™ Hose: 0,7m with OD15mm brass tail *

Available for various media. Please replace XX with the relevant media:

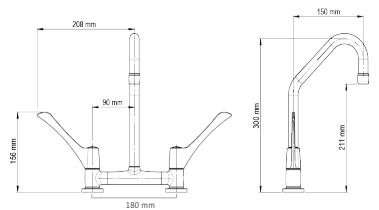
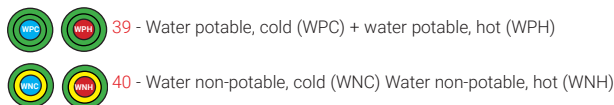

### Water / Divided flow

### Bench mounted

Bench mounted divided flow mixer with areator

Weight: Approx. 2.2 kg

XL 36 155 82 XX - 14	60 mm, 1/2" ISO 7/1-R - UniFlex™ *
XL 36 155 82 XX - 14H	60 mm, 1/2" ISO 7/1-R - UniFlex™ Hose: 0,7m with OD15mm brass tail *

Available for various media. Please replace XX with the relevant media:

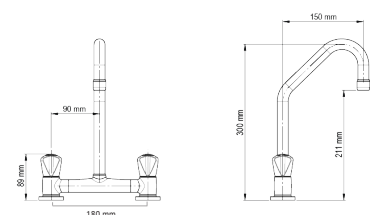
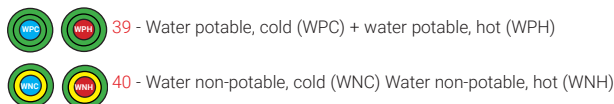

### Water / Divided flow

### Bench mounted

Bench mounted divided flow mixer with areator and wrist action levers.

Weight: Approx. 2.5 kg

XL 36 154 82 XX - 14	60 mm, 1/2" ISO 7/1-R - UniFlex™ *
XL 36 154 82 XX - 14H	60 mm, 1/2" ISO 7/1-R - UniFlex™ Hose: 0,7m with OD15mm brass tail *

Available for various media. Please replace XX with the relevant media:

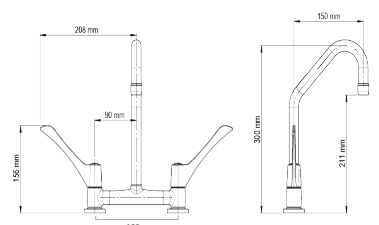
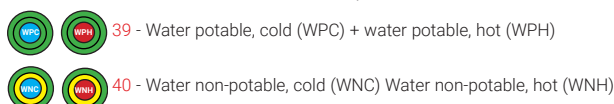

\* See page 25 for information on Inlet design, drilling template and information about thread.

## Water mixers

### Water

### Bench mounted

Bench mounted single hole mixer with swivel swanneck and fixed nozzle.

Weight: Approx. 2.2 kg

XL 36 039 82 XX - 52E	60 mm, m30x1.5, *
XL 36 039 82 XX - 52H	60 mm, m30x1.5, Hose: 0,7m with OD15mm brass tail *

Available for various media. Please replace XX with the relevant media:

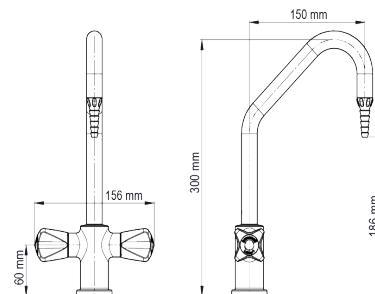
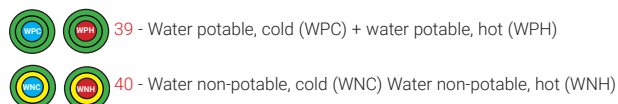

### Water

### Bench mounted

Bench mounted single hole mixer with swivel swanneck and fixed nozzle and wrist action levers.

Weight: Approx. 2.5 kg

XL 36 041 82 XX - 52E	60 mm, m30x1.5, *
XL 36 041 82 XX - 52H	60 mm, m30x1.5, Hose: 0,7m with OD15mm brass tail *

Available for various media. Please replace XX with the relevant media:

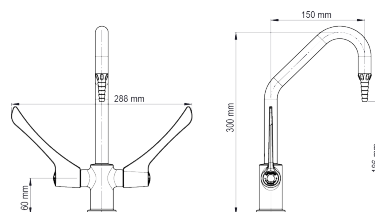
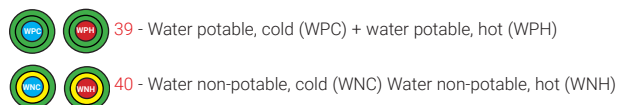

## Accessories

BROEN-LAB Uniflex™ compression ring for water. Fits 15mm CU pipe.

Can be used with all water taps with the inlet connection -14.

15 212 330	Weight: 0,08 kg
	Media: Water
	Approval: WRAS

CU Pipe and support bush not included

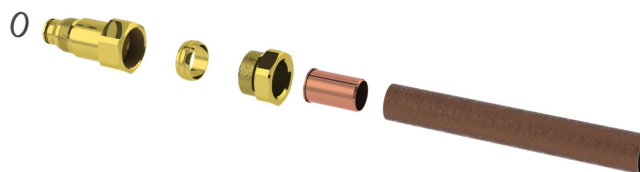



## Lift/turn gas taps

### Burning gas

### Bench mounted

Bench mounted one-way lift & turn gas fitting.

Weight: Approx. 0.5 kg

XL 99 561 82 XX - 14	60 mm, 1/2" ISO 7/1-R - UniFlex *
----------------------	-----------------------------------

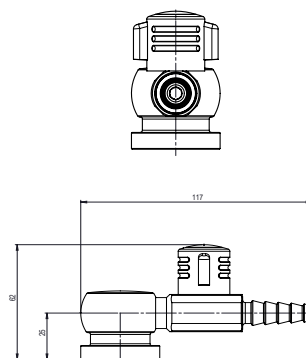

Available for various media. Please replace XX with the relevant media:



10 - Natural gas (G)



12 - Liquefied petrol gas (LPG)

### Burning gas

### Bench mounted

Bench mounted two-way lift & turn gas fitting in 90°.

Weight: Approx. 0.7 kg

XL 99 562 82 XX - 14	60 mm, 1/2" ISO 7/1-R - UniFlex *
----------------------	-----------------------------------

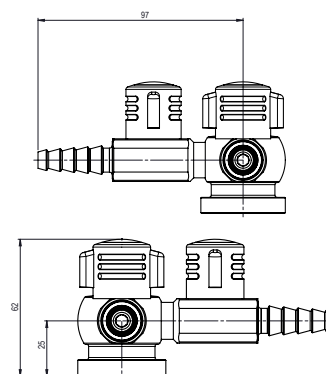

Available for various media. Please replace XX with the relevant media:



10 - Natural gas (G)



12 - Liquefied petrol gas (LPG)

### Burning gas

### Bench mounted

Bench mounted two-way lift & turn gas fitting in 180°.

Weight: Approx. 0.7 kg

XL 99 577 82 XX - 14	60 mm, 1/2" ISO 7/1-R - UniFlex *
----------------------	-----------------------------------

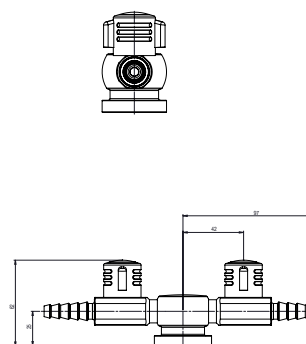

Available for various media. Please replace XX with the relevant media:



10 - Natural gas (G)



12 - Liquefied petrol gas (LPG)

### Burning gas

### Bench mounted

Bench mounted four-way lift & turn gas fitting.

Weight: Approx. 1.0 kg

XL 99 578 82 XX - 14	60 mm, 1/2" ISO 7/1-R - UniFlex *
----------------------	-----------------------------------

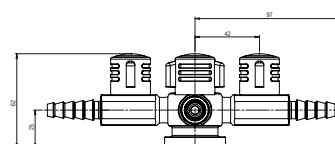

Available for various media. Please replace XX with the relevant media:



10 - Natural gas (G)



12 - Liquefied petrol gas (LPG)

\* See page 25 for information on Inlet design, drilling template and information about thread.

## Lift/turn gas taps

### Burning gas

### Wall/Suspended mounted

Wall/suspended mounted one-way lift & turn gas valve.

Weight: Approx. 0.1 kg

XL 20 397 82 XX	ISO 7/1 G3/8" A
-----------------	-----------------

Available for various media. Please replace XX with the relevant media:



10 - Natural gas (G)



12 - Liquefied petrol gas (LPG)

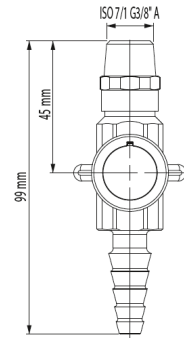

### Burning gas

### Wall/Suspended mounted

Wall/suspended mounted one-way lift & turn gas fitting.

Weight: Approx. 0.7 kg

XL 20 722 82 XX-14	60 mm, 1/2" ISO 7/1-R - UniFlex *
--------------------	-----------------------------------

Available for various media. Please replace XX with the relevant media:



10 - Natural gas (G)



12 - Liquefied petrol gas (LPG)

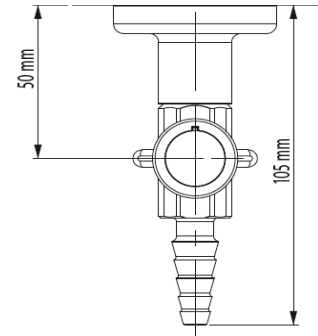

### Burning gas

### Wall/Suspended mounted

Wall/suspended mounted two-way lift & turn gas fitting in 90°.

Weight: Approx. 1.2 kg

XL 20 116 82 XX-14	60 mm, 1/2" ISO 7/1-R - UniFlex *
--------------------	-----------------------------------

Available for various media. Please replace XX with the relevant media:



10 - Natural gas (G)



12 - Liquefied petrol gas (LPG)

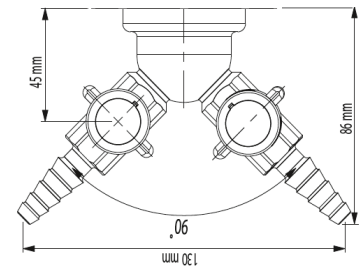
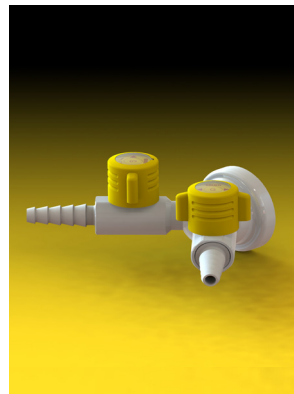

### Burning gas

### Wall/Suspended mounted

Wall/suspended mounted two-way lift & turn gas fitting in 90° with wall flange socket.

Weight: Approx. 0.6 kg

XL 20 724 82 XX	Wall flange socket for exposed piping
-----------------	---------------------------------------

Compression fitting, for wall flange socket (UniFlex™):

CU-pipe OD 10mm = 15215220

CU-pipe OD 12mm = 15215300

CU-pipe OD 15mm = 15212350

Available for various media. Please replace XX with the relevant media:



10 - Natural gas (G)



12 - Liquefied petrol gas (LPG)

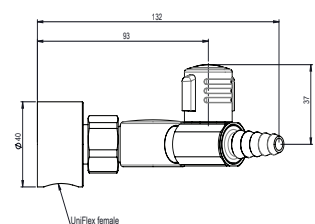

\* See page 25 for information on Inlet design, drilling template and information about tread.

# brownall Labtap®

## Accessories

Burning gas

Bench mounted

BROEN-LAB UniFlex™ compression fitting for OD 15mm CU pipe.  
Can be used with all burning gas taps with the inlet connection -14.

15 212 350	Media: Burning gas Weight: 0,08 kg Approval: BSI
------------	--

CU Pipe and support bush not included

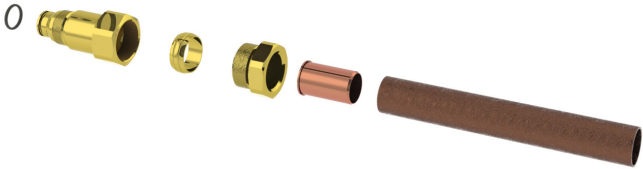

Burning gas

## Emergency Shower Systems

### First aid kit

Standard First Aid Kit which contains

- Clean pads
- Cool pads
- Stop dressing
- Elastic band aids x 2
- Sterile eye wash
- pH eye wash
- Signs
- Instruction sheets
- First Aid Plans

P7330051000002	First Aid Kit
----------------	---------------



### Safety

### Wall mounted

Wall mounted eye shower with bowl.

Min. working pressure: 1 bar,

Weight: Approx. 3 kg.

17 528 009	Female G3/4"
------------	--------------

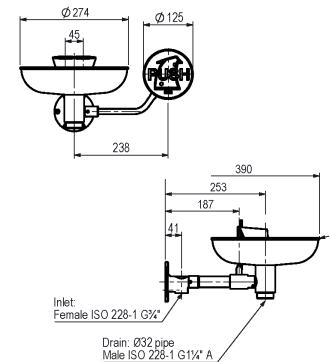

### Safety

### Wall mounted

Wall mounted eye shower with 45° single angled heads incl. 1.5 m inlet hose. Trigger operated built-in checkvalve and FLOWFIX for regulation of water flow (14 l/min). Min. working pressure: 1.5 bar.

Weight: Approx. 0.5 kg.

27 10 003 10 03 011	1,5 m inlet hose, G 1/2" union nut
---------------------	------------------------------------

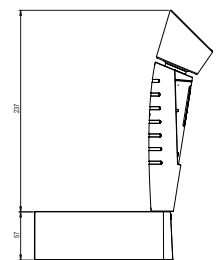
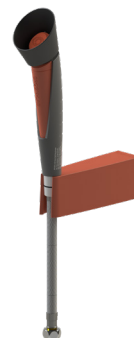
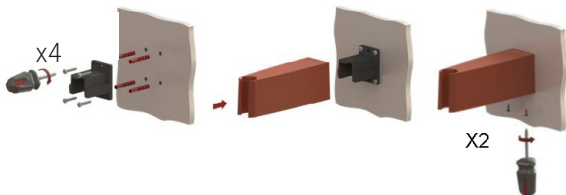

### Safety

### Wall mounted

Wall mounted eye shower with 45° double angled heads incl. 1.5 m inlet hose. Trigger operated built-in checkvalve and FLOWFIX for regulation of water flow (14 l/min). Min. working pressure: 1.5 bar.

Weight: Approx. 0.5 kg.

27 10 009 10 03 011	1,5 m inlet hose, G 1/2" union nut
---------------------	------------------------------------

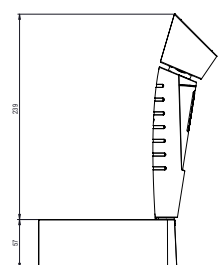
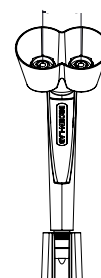
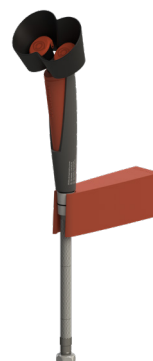
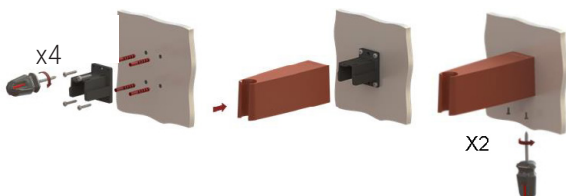

# brownall Labtap®

## Emergency Shower Systems

### Safety

### Bench mounted

Bench mounted eye shower with 45° single angled heads incl. 1.5 m inlet hose. Trigger operated built-in checkvalve and FLOWFIX for regulation of water flow (14 l/min). Min. working pressure: 1.5 bar.

Weight: Approx. 0.5 kg.

27 10 003 10 05 011	1,5 m inlet hose, G 1/2" union nut
---------------------	------------------------------------

Drilling template  
M30x1,5

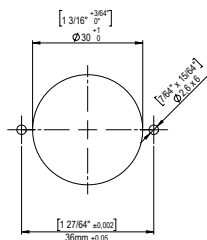

Thread

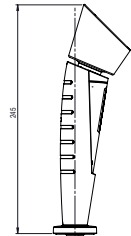
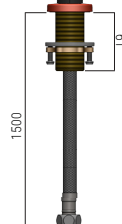

### Safety

### Bench mounted

Bench mounted eye shower with 45° double angled heads incl. 1.5 m inlet hose. Trigger operated built-in checkvalve and FLOWFIX for regulation of water flow (14 l/min). Min. working pressure: 1.5 bar.

Weight: Approx. 0.5 kg.

27 10 009 10 05 011	1,5 m inlet hose, G 1/2" union nut
---------------------	------------------------------------

Drilling template  
M30x1,5

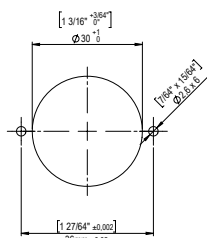

Thread

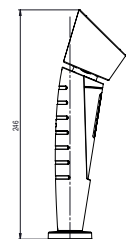
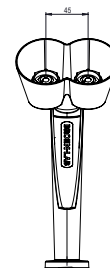
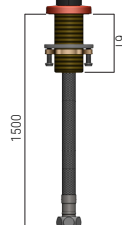

Hand/eye shower

Eyeshowers are a part of the BROEN-LAB Emergency Shower System. See the Emergency Shower Catalogue on:  
[https://www.broen-lab.com/products/brochures/product-brochures/#Paragraph\\_2085](https://www.broen-lab.com/products/brochures/product-brochures/#Paragraph_2085)

### Safety

### Test cylinder

Measuring cylinder for test of eye showers.

Weight: Approx. 0.5 kg.

27 99 008 1001	Ø250mm - 349mm
----------------	----------------

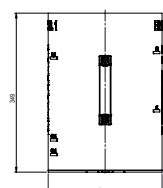

# brownall Labtap®

## Emergency Shower Systems

Safety

Freestanding

Freestanding body shower with eye/face shower and bowl, modular.  
Min. working pressure: 1.5 bar.

Weight: Approx. 17 kg.

17 656 009	Female ISO 228-1 G1
------------	---------------------

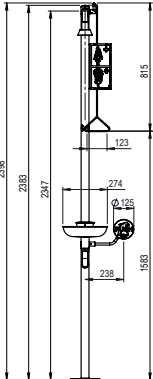
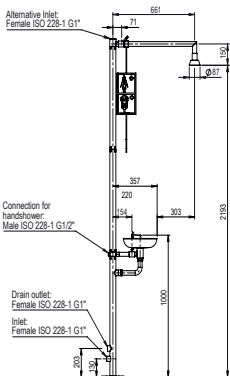
Safety

Wall mounted

Wall mounted body shower for exposed pipework with self-draining head. Min. working pressure: 1 bar,

Weight: Approx. 3 kg.

17 582 009	Female G3/4"
------------	--------------

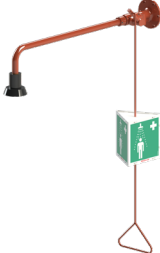
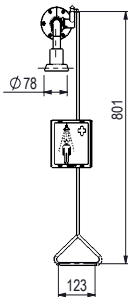
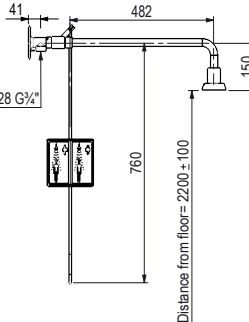
Safety

Wall mounted

Wall mounted body shower with self-draining head.

Min. working pressure: 1 bar,

Weight: Approx. 3 kg.

17 575 009	Female G1"
------------	------------

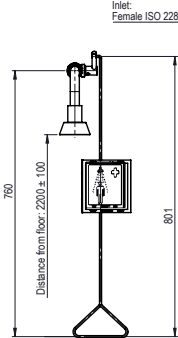
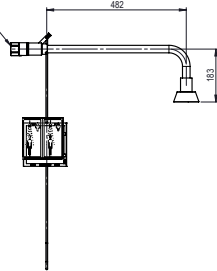
Safety

Test trolley

Test trolley for emergency showers. With integrated pump, 8 m connection cable and UK-plug. 90 L capacity.

Weight: Approx. 22 kg.

17 851 929-UK	Draining hose included
---------------	------------------------

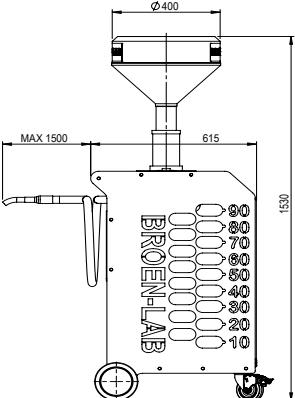

## Chemical waste

All full range accessories are available for our bottle traps and drip cup fittings. Our bottle traps are designed to be adaptable for use on either Metric or Imperial pipe size and incorporate an adjustable height by the use of a sliding tube on the neck of the fitting. Compared with competitor's products this feature gives installers greater flexibility on installation and can also reduce the time and cost of installation considerably.

### Chemical Waste

6008 Standpipe for waste fitting

457 mm long



6013 Outlet adaptor

for 6003/6023, to give

1 1/4" male connection

1 1/2" outlet



6007 Standpipe for waste fittings

200 mm long



6010 Waste fitting

70 mm flange

1 1/2" outlet

(110 mm long)



6005 Waste fittings

85 mm flange

1 1/2" outlet

(110 mm long)



6015 Waste fitting

with overflow assembly and banjo

70 mm flange



6011 Waste fitting

with overflow assembly and banjo

85 mm flange



6011-24 24" Waste fitting

with overflow assembly and banjo

85 mm flange

Overflow tube has longer dimensions (24")



## Chemical waste

BROEN-LAB chemical waste products are specifically designed to enhance the appearance of modern work tops fitted in today's laboratories. Manufactured from polypropylene, they give a high resistance to most of the chemicals currently used in laboratories.

The standard range of fittings are finished in polished black. However, to special order, the drip cups can be supplied in a variety of colours. Standard items are normally available on an ex-stock basis, BROEN-LAB chemical waste products are not only competitively priced but produce to a high standard of quality control (ISO 9001).

### Chemical Waste

**6000 Large oval drip cup**  
(84 mm x 240 mm cut-out)  
1 1/2" outlet



**6001 Small oval drip cup**  
(84 mm x 162 mm cut-out)  
1 1/2" outlet



**6002 Small circular drip cup**  
(90 mm dia cut-out)  
1 1/2" outlet



**6014 Large circular drip cup**  
(144 mm dia cut-out)  
1 1/2" outlet



**6023 Anti-syphon bottle trap**  
Adjustable height neck - requires adaptor 6009, 6012 or 6013 to connect to pipework.



**6003 Bottle trap**  
(not anti-syphon) adjustable height neck - requires adaptor 6009, 6012 or 6013 to connect to pipework.



**6012 Outlet adaptor**  
for 6003/6023, to suit 40 mm OD pipe.



**6018 Slotted waste fitting**  
85 mm flange with large size back nut



**6009 Outlet adaptor**  
for 6003/6023, to suit 38 mm OD pipe.



## Sinks and waste

### Sink

Injection moulded from polypropylene copolymer resin, with a self-draining base. This square PP sink blends well into any laboratory work-bench. Extremely durable.

97B0350	Black
97B0350W	White

Remember to order 97B0073 or 97B0073W for waste connection

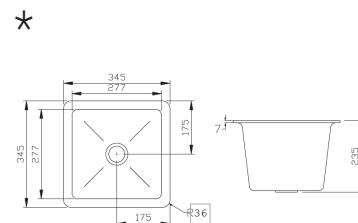

### Sink

Injection moulded from polypropylene copolymer resin, with a self-draining base. Designed for mounting on top or underside of the work benches.

97B0420	Black
---------	-------

Remember to order 97B0073 for waste connection

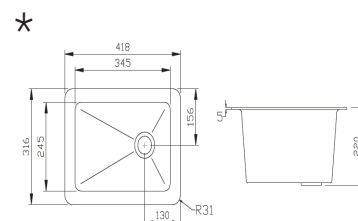

### Sink

The rectangular sink with its self draining base are injection moulded from polypropylene copolymer resin. Designed for mounting on top or underside of work benches.

97B0552	Black
97B0552W	White

Remember to order 97B0073 or 97B0073W for waste connection

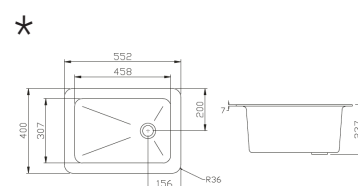

### Sink

The largest polypropylene sink offered, it is suitable for cleansing of larger items. Very widely used in island benches and teacher benches.

97B0810	Black
---------	-------

Remember to order 97B0085 for waste connection

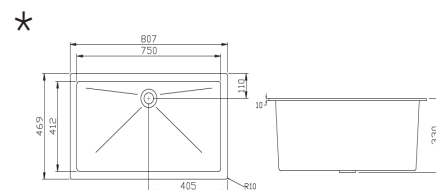

### Sink

Waste for sinks. Including adjustable screw on nut

97B0073	Black, Ø73
97B0073W	White, Ø73
97B0085	Black, Ø85

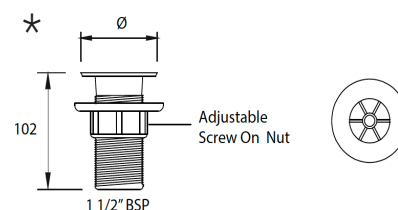

\* Measurements can vary due to material property in the molding and cooling process. We don't recommend cutting until sinks have been received and measurements have been checked. PP-material have a high chemical resistance and therefore glue can't be used as fastening method.

\* See page 25 for information on Inlet design, drilling template and information about thread.

## Accessories

### Water

### Aerator

Aerator for water fittings.

15 80 011	M19x1 (For XL34- and XL36-series)
15 80 013	ISO228/1-G3/8 (For XL33-series)

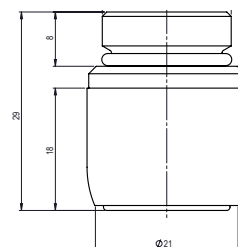
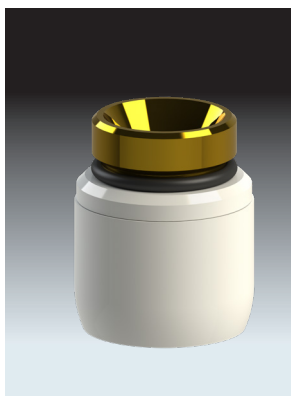

### Water

### Pipe interruptor

Pipe interruptor with permanent atmospheric vent. Back flow preventer to be mounted between the spout and nozzle.

Back flow preventer for XL34- and XL36-series, for removable nozzle, order nozzle 25390081001 with thread female G1/2

15 279 559	Male M19 x 1, Male G1/2
------------	-------------------------



### Water

### Pipe interruptor

Pipe interruptor with permanent atmospheric vent. Back flow preventer to be mounted between the spout and nozzle.

Back flow preventer for all water outlets with removable nozzle. Existing nozzle can then be remounted.

15 279 569	Female G1/2", Male G1/2"
------------	--------------------------



### Water

### Pipe interruptor

Pipe interruptor with permanent atmospheric vent. Back flow preventer to be mounted between the spout and nozzle.

Back flow preventer for XL33- and elder spouts, for removable nozzle order nozzle 25390081001 with thread female G1/2

15 279 579	Male G3/8", Male G1/2"
------------	------------------------



## Accessories

### Water

### Nozzle

Fixed plastic nozzle for water fittings.

25 39 010 1001	M19x1 (For XL34- and XL36-series)
25 39 040 1001	ISO228/1-G3/8 (For XL33-series)

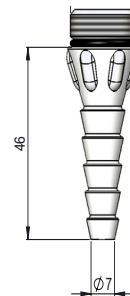

### Water

### Nozzle

Removable plastic nozzle for water fittings.

25 39 004 1001	Plastic nozzle (choose adaptor according to series below)
----------------	---

Adaptor according to series.

25 39 003 1001	M19x1 (For XL34- and XL36-series)
25 39 040 1001	ISO228/1-G3/8 (For XL33-series)

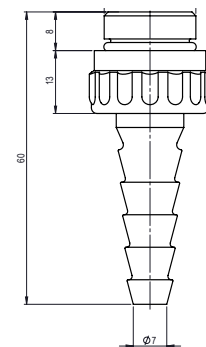

### Water

### Wrist operated handle

Complete metal elbow lever with ceramic headwork

See page 24 for more information about headworks

WPC and WPH buttons are delivered as a standard. For other media please contact your sales representative.

15 80 008	Elbow lever complete, Left hand closing
15 80 009	Elbow lever complete, Right hand closing

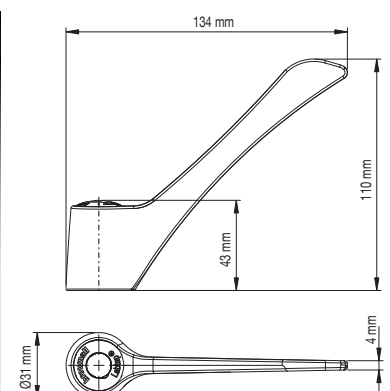

### Water

### Handle

Complete plastic handle with compress headwork

See page 24 for more information about headworks

WPC and WPH buttons are delivered as a standard. For other media please contact your sales representative.

15 80 017	Handle complete with headwork, ring and button.
-----------	---

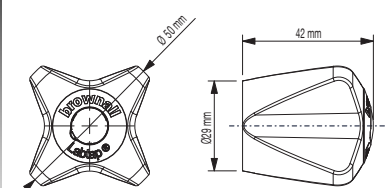
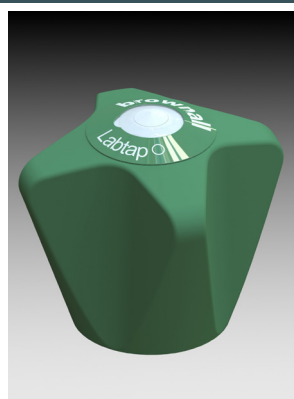

\* See page 25 for information on Inlet design, drilling template and information about thread.

## Accessories

### Water

### Vacuum pump

Water jet vacuum pump serrated nozzle

Fits all water outlets with removable nozzle.

Weight: Approx. 0.5 kg

19 199 009

Water jet filter pump

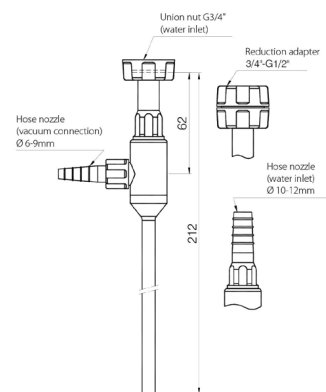

### All media

### Mounting kit G $\frac{1}{2}$ "

Complete mounting kit for fittings with G1/2 mounting connection.

19 141 000

Complete mounting kit  $\frac{1}{2}$ "

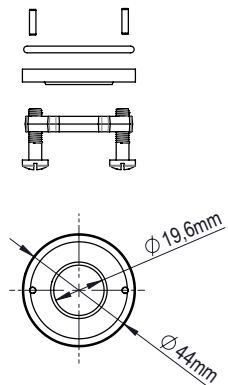
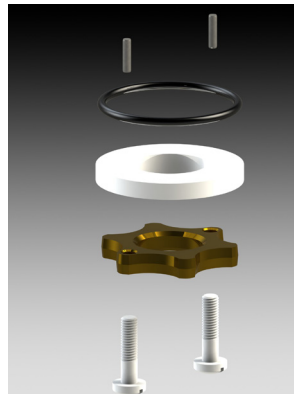

### All media

### Mounting kit M30 x 1.5

Complete mounting kit for fittings with M30x1.5 mounting connection.

19 142 000

Complete mounting kit M30x1.5

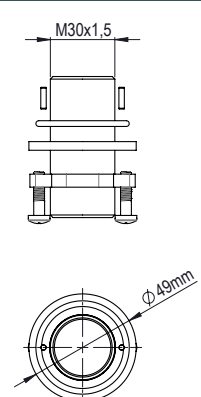

Other options:

19 143 000 - 30 mm

19 144 000 - 90 mm

### All media

### Bordprop

End cap Blank-off cover

19 640 009

ISO228/1 G1/2"

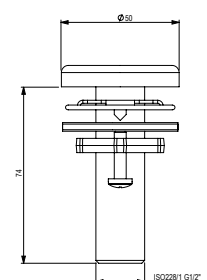
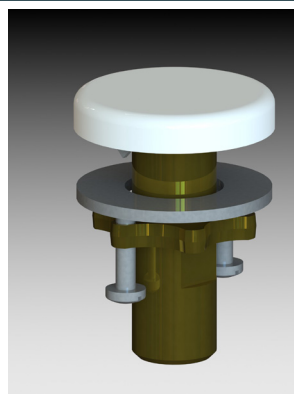



### Water fittings

The range of water fittings have been designed to meet the requirements of EN 200 (Specification for the performance of draw off taps with metal bodies for water service).

#### SPECIFICATION

Brass with sealing in EPDM and PVDF. Wrist operated fittings have ceramic headwork's made of Al-oxide.

Most water fittings are delivered with plastic (PP) hose nozzles.

Handles of chemical resistant polypropylene, coloured to match the service medium in accordance with BS EN 13792:2002.

All fittings are protected by a surface treatment of Polyester powder coat which is highly resistant to most chemicals.

#### Outlets

Serrated plastic nozzles (fixed or removable) suitable for 8 mm to 13 mm ID rubber tubing or aerator are fitted on request.

#### Inlet connections

See overview on page 25

#### Installation

Installation of fittings can be done either with flexible hoses or compression ring fittings. Please request documents 99G0005 and 99G0004 for more information.

It is a condition of Approval of the XL range of Labtaps that the following information is given to our customers: "Supply shall be by gravity from a cistern by means of a distributing pipe which does not supply any other fitting at a lower level" (IRN 105) (Byelaws 22 and 25)

All water systems should be thoroughly flushed before use.

All fittings are delivered with easy-to-mount anti-rotational mounting kit.

#### AUK3 regulations

Check with local water board their requirements regarding AUK3 back flow prevention regulations. It is required that a minimum of 150 mm be maintained between the lowest point of the air aperture of the DC device and free discharge of spillover level.

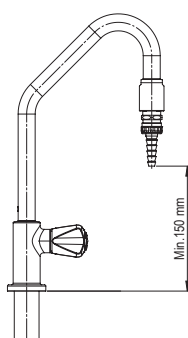

#### Testing

All fittings are tested and inspected before dispatch.

Maximum design working pressure is 1000 kPa (10 bar).

The maximum installation test pressure is 1000 kPa (10 bar).

#### Single Water Fittings

All swanneck fittings are supplied with a fixed plastic nozzle with exception for those with pipe interrupter, which are delivered with a removable hose nozzle.

All fittings coded according to EN13792-2002 (please refer to page 3 for media coding).

#### Mixer Fittings

A balanced tank storage water supply for BOTH hot and cold services is required for all non-divided flow mixer fittings.

Direct mains cold water supply and non-pressurized hot water tanks may ONLY be used with the XL36155 and the XL36154 (divided flow) mixer.

NOTE: Maximum Test Pressure: 1000 kPa (10 bar).

Maximum Working Pressure: 1000 kPa (10 bar).

## Technical information

### Lift/turn fittings

#### SPECIFICATION

##### Outlet Connections:

Fixed serrated metal nozzles suitable for 8 mm to 13 mm ID rubber tubing.

##### Inlet Connections:

See page 25

##### Installation

Installation can be done either with flexible hoses or compression ring fittings.

Please request documents 99G0005 and 99G0004 for more information.

##### Construction:

Brass body.

##### Connection:

Fitting connection is a 1/4" BSP male threaded shank 65 mm long. The connection end of the shank is designed to fit 8 mm BS 27871 Table X tubing using a compression nut.

NOTE: The use of compression fittings, if used for domestic gas or LPG, should be in accordance with gas board regulations.

##### Seals:

Nitrile.

##### Testing

All fittings are tested and inspected before dispatch.

Maximum design Test Pressure: 1000 kPa (10 bar).

Maximum design Working Pressure: 700 kPa (7 bar).

### Drop lever fittings

#### SPECIFICATION

Outlet Connections: Fixed serrated nozzles suitable for 8 mm to 13 mm ID rubber hose.

##### Construction:

Fire safe plug cocks of brass constructed using grease suitable for Natural Gas and LPG.

##### Installation

Supply pressure should be in the range from 1.5 kPa to 5 kPa.

A qualified installer should be used. LPG supplies should be regulated locally in order to prevent pressure surges.

NOTE: The maximum possible pressure should never exceed 5 kPa.

##### Connection:

Fitting connection is a 1/4" BSP male threaded shank 65 mm long. The connection end of the shank is designed to fit 8 mm BS 27871 Table X tubing using a compression nut.

NOTE: The use of compression fittings, if used for domestic gas or LPG, should be in accordance with gas board regulations.

##### Testing

All drop lever gas cocks components are tested at 135 kPa before despatch (based on BS 1552). Finally assembled drop lever gas cocks are tested at 13,8 kPa.

Installation test pressures on systems incorporating drop lever gas cocks should NOT EXCEED 13,8 kPa otherwise the lubricant will be blown out and the cocks may leak.

A competent Gas Engineer should always test Natural Gas installations.

Leakage should be checked using soap and water or trapped pressure drop over 15 minutes.

## Headworks

### Water

### Compress Headwork

Headwork for water.

Open/closing function: 2 x 360°.

Maximum test pressure without function of the valve: 10 bar.

Temperature: Max. 90°C.

Leak rate: 15 mm³/sec. at 6 bar compressed air (differential pressure method).

19 77 000	Compress headwork water
-----------	-------------------------

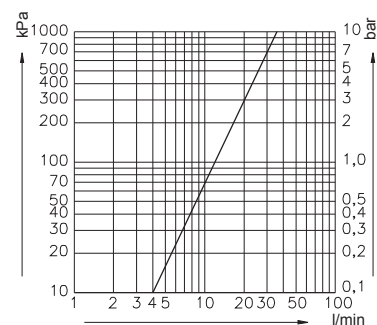

### Water

### Ceramic Headwork

Headwork used for wrist operated fittings for water.

Open/closing function: 90° (right or left hand).

Maximum test pressure without function of the valve: 10 bar.

Temperature: Max. 90°C.

Leak rate: 15 mm³/sec. at 6 bar compressed air (differential pressure method).

19 76 400	Ceramic headwork cold water
19 76 500	Ceramic headwork hot water

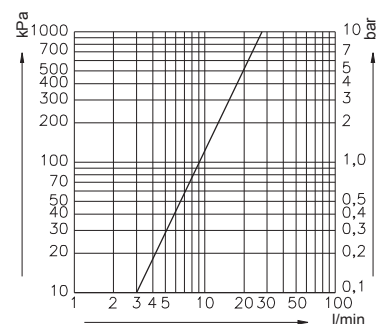



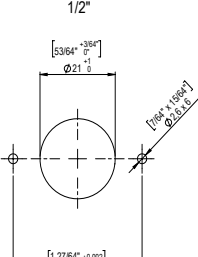
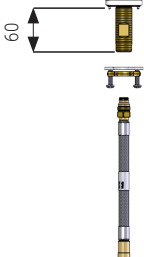
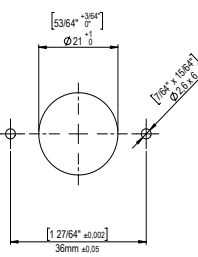
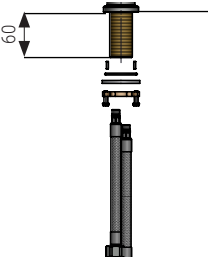
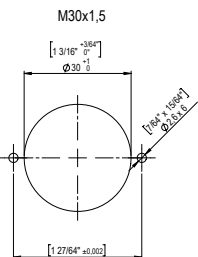
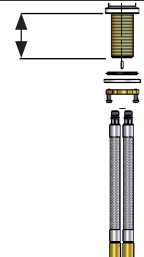
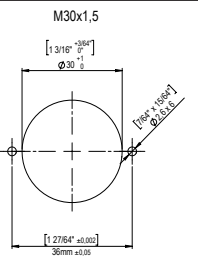

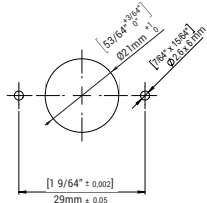



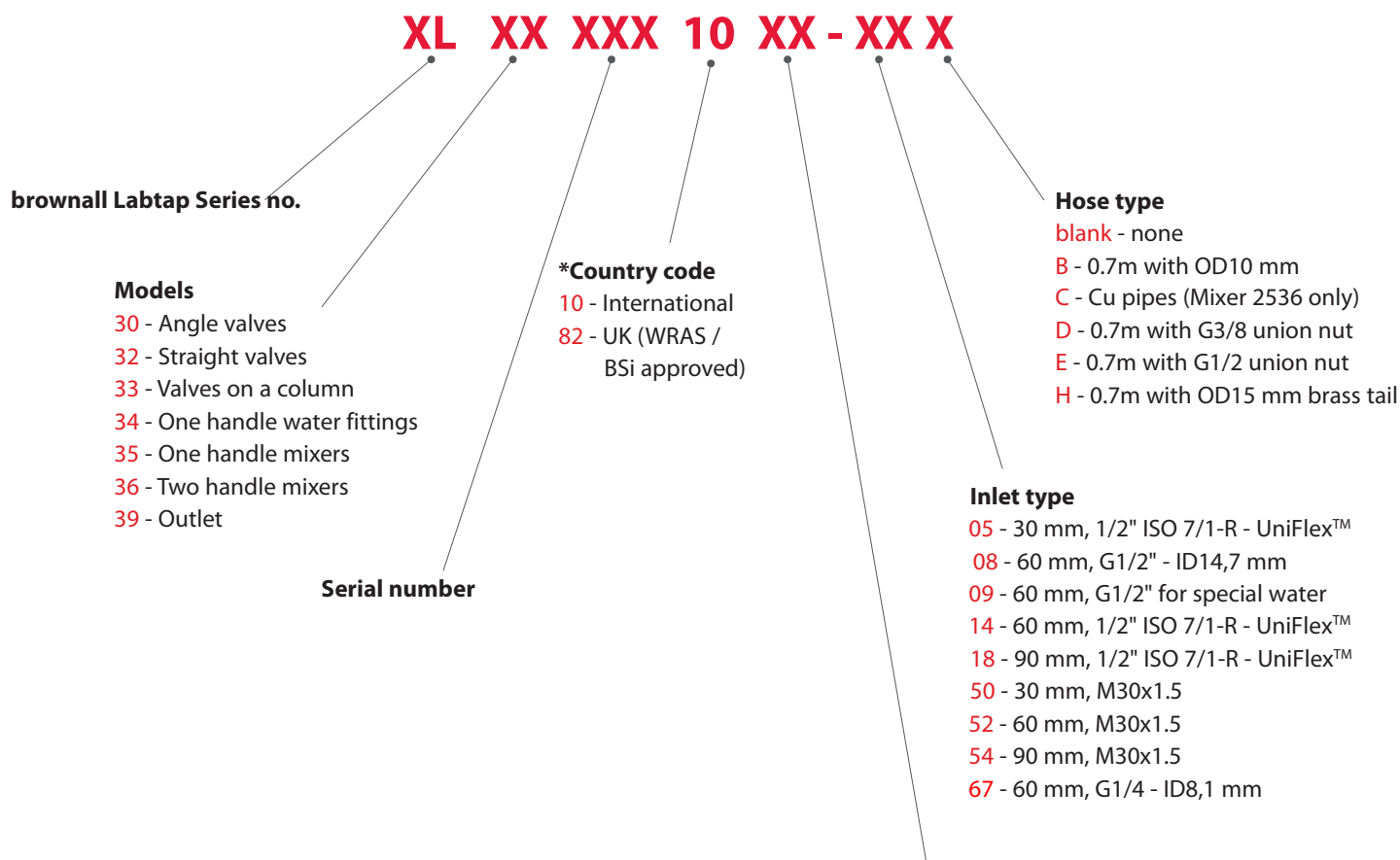



















## Inlet, drilling, template & threads

Water			
Intlet number	Inlet design	Drilling template	Thread
-14			60 mm, 1/2" ISO 7/1-R - UniFlex
-14H			60 mm, 1/2" ISO 7/1-R - UniFlex Hose: 0,7m with OD 15 mm brass tail
-52E			60mm, M30x1.5, Hose: 0,7m with 1/2" union nut
-52H			60 mm, M30x1.5, Hose: 0,7m with OD 15 mm brass tail

Gas			
Intlet number	Inlet design	Drilling template	Thread
-14			60 mm, 1/2" ISO 7/1-R - UniFlex

## Product number configurator



Media code	
 01 - Water potable, cold (WPC)	 23 - Nitrogen (N <sub>2</sub> )
 02 - Water potable, hot (WPH)	 24 - Carbon Dioxide (CO <sub>2</sub> )
 03 - Distilled water (WDI)	 25 - Argon (Ar)
 07 - Water non-potable, cold (WNC)	 26 - Helium (He)
 08 - Water non-potable, hot (WNH)	 27 - Dinitrogen monoxide, nitrous oxide (N <sub>2</sub> O)
 09 - Natural gas (G)	 28 - Low vacuum - 100 kPa to 0,1 kPa (V)
 11 - Liquified petrol gas (LPG)	 29 - Fine vacuum - 0,1 kPa to 0,001 kPa (VF)
 13 - Butane (C <sub>4</sub> H <sub>10</sub> )	 30 - High vacuum - 0,1 kPa to 0,0000001 kPa (VH)
 15 - Propane (C <sub>3</sub> H <sub>8</sub> )	 35 - Tempered water (one handle mixer)
 17 - Acetylene (C <sub>2</sub> H <sub>2</sub> )	 36 - Deionised water, cold (WDC)
 19 - Hydrogen (H <sub>2</sub> )	  39 - Water potable (WPC /WPH)
 21 - Compressed air (CA)	  40 - Water non-potable (WNC /WNH)
 22 - Oxygen (O <sub>2</sub> )	 46 - Methane (CH <sub>4</sub> )

## Notes

This image shows a single sheet of white paper with horizontal ruling lines. The lines are evenly spaced and run across the width of the page. There are no margins, text, or other markings on the paper.



## Notes

This image shows a single sheet of white paper with horizontal ruling lines. The lines are evenly spaced and run across the width of the page. There are no margins, text, or other markings on the paper.

# **brownall Labtap®**

**Please contact your local representative for more information.**

# **brownall Labtap®**

**[www.brownall-labtap.co.uk](http://www.brownall-labtap.co.uk)**

Phone +44 ( 0)121 522 2225

E-mail: [sales@brownall-labtap.co.uk](mailto:sales@brownall-labtap.co.uk)